

west

THE PROPERTY CONSULTANCY

Stepstone House Old Moor, Abingdon, OX14 4ED

Guide Price £650,000

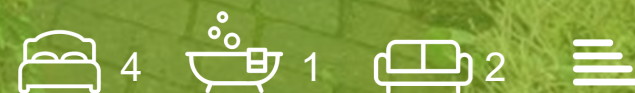



## Floor Plan

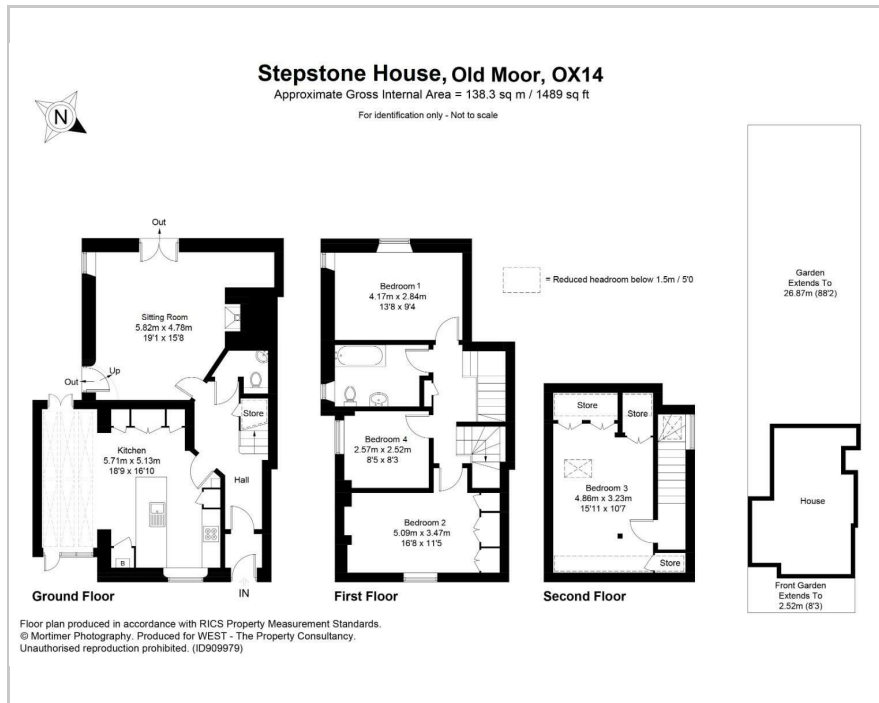

## Area Map

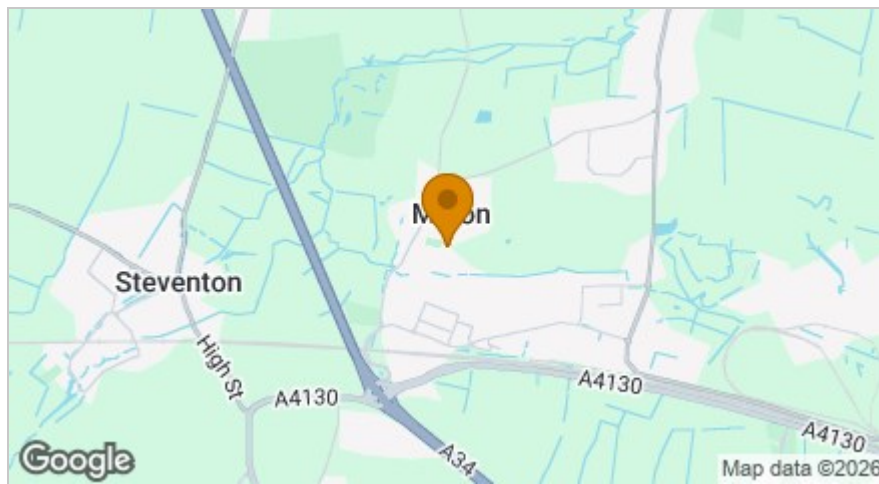

An elegant period home (origins in 17th Century) of charm in a rural setting yet within a 10 minute drive of Didcot rail station with its fast links to London Paddington. 3 bedrooms, stylish kitchen/dining room with underfloor heating, high-ceilinged drawing room, outlook over farmland.

- Period Village Home (Listed Grade 2) c17th Century
- South West Facing Garden (circa 88ft)
- 3 Double Bedrooms plus Office/Bedroom 4
- Bright & Airy Fitted Kitchen/Dining Room with Fabulous Mural
- Fibre Broadband to the house (circa 1Gbps)
- Outlook over Farmland to the East
- Very Accessible Country Walks
- Signal Yard, Milton Park with Cafes & Restaurants opening 2026 (1km)
- Easy access to Didcot Rail Station and A34,
- Double Glazing and Gas Central Heating

**DIRECTIONS:** From Oxford take the A34 South and come off at the Milton junction, signposted Didcot, Milton, Wantage. At the roundabout take the first exit to Milton and then first left after about 450m to Milton village. After about 400 metres turn right into School Lane before the sign to Milton Manor and the Plum Pudding Inn. After 175m the recreation ground will be on your right hand side and as the road becomes Old Moor, Stepstone House will be the second property on your right.



216 Banbury Road, Oxford, OX2 7BY

Tel: 01865 510000 Email: [oxford@west-tpc.co.uk](mailto:oxford@west-tpc.co.uk) <https://www.west-tpc.co.uk>

These particulars, whilst believed to be accurate are set out as a general outline only for guidance and do not constitute any part of an offer or contract. Intending purchasers should not rely on them as statements of representation of fact, but must satisfy themselves by inspection or otherwise as to their accuracy. No person in this firm's employment has the authority to make or give any representation or warranty in respect of the property.